



jordan fishwick

WEST DIDSBURY
The Boulevard



The Boulevard, West Didsbury, M20 2EU

Offers Over £600,000



The Property

Deceptively spacious is a word that can be genuinely used to describe this superb, extended, semi-detached townhouse offering over 1850 sq ft of living space on three floors, presented to an extremely high standard with quality fittings throughout and an ideal location which is just a short stroll to Burton Road and its array of cafés, restaurants & independent shops, and within close proximity of Cavendish Road Primary and Didsbury High School.

The numerous noteworthy features include an impressive, extended, open plan living/kitchen area with a comprehensive range of units, matching breakfast bar and bi-fold doors to the enclosed rear garden, a generous front reception room and downstairs WC. The first floor provides three excellent double bedrooms, the main with en-suite shower room and fitted wardrobes, and the family bathroom, whilst on the second floor is an impressive master bedroom with en-suite shower room, dressing area with fitted wardrobes, excellent eaves storage space and a nice sized balcony with elevated views.

Externally, there is an enclosed and easy to maintain garden, with useful brick store (11'8" x 5'2"), allocated gated parking for two vehicles beyond and a small garden area to the front.

****FREEHOLD****

Directions

M20 2EU



- Impressive semi detached townhouse
- Full-width ground floor extension
- Living space over three floors
- Four excellent double bedrooms
- Three bathrooms & downstairs WC
- Superb open plan living kitchen
- Generous balcony & eaves storage
- Enclosed garden & brick store
- Gated allocated parking
- Great location in West Didsbury

Postcode - M20 2EU

EPC Rating - C

Floor Area - 1872.00 sq ft

Local Authority - Manchester City Council

Council Tax - F



GROUND FLOOR
746 sq.ft. (69.3 sq.m.) approx.

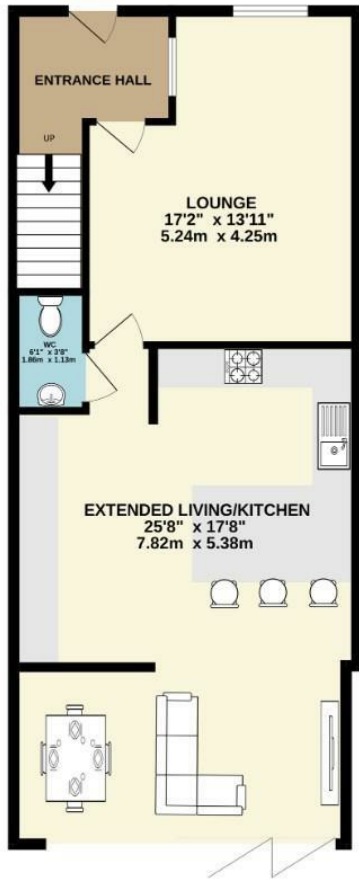

1ST FLOOR
623 sq.ft. (57.9 sq.m.) approx.

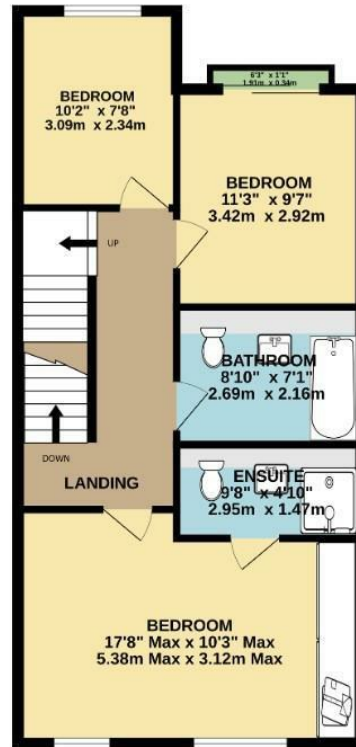

2ND FLOOR
503 sq.ft. (46.7 sq.m.) approx.

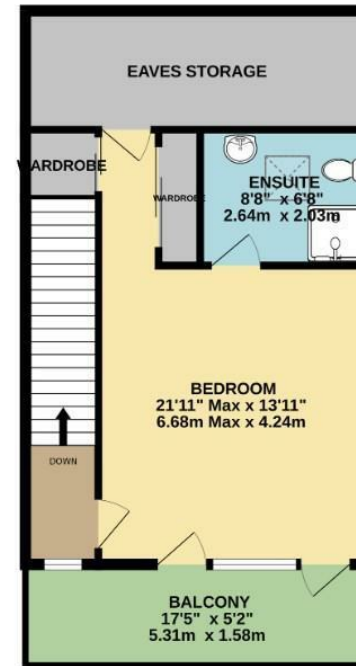

TOTAL FLOOR AREA: 1872 sq.ft. (173.9 sq.m.) approx.
Measurements are approximate. Not to scale. Illustrative purposes only
Made with Metropix ©2026



These particulars are believed to be accurate but they are not guaranteed and do not form a contract. Neither Jordan Fishwick nor the vendor or lessor accept any responsibility in respect of these particulars, which are not intended to be statements or representations of fact and any intending purchaser or lessee must satisfy himself by inspection or otherwise as to the correctness of each of the statements contained in these particulars. Any floorplans on this brochure are for illustrative purposes only and are not necessarily to scale.

Offices also at: Wilmslow, Macclesfield, Hale, Sale, Chorlton, Glossop, Manchester & Salford

757-759 Wilmslow Road, Didsbury Village, Manchester

0161 445 4480

didsbury@jordanfishwick.co.uk
www.jordanfishwick.co.uk